

LOCTITE[®]
TECHNOMELT[®]
TEROSON[®]
AQUENCE[®]

Adhesives for Furniture and Building Components



Introducing Ourselves

Henkel is world market leader in the range of bonding, a key technology of the 21st century. Henkel adhesive solutions are used in a diverse range of markets encompassing transportation, electronics, aerospace, metal bonding, packaging as well as in the building and furniture industry.



A key factor to our customer focus is constant dialogue with the Henkel team to demonstrate continuous improvement of industrial products and manufacturing processes resulting in a true supplier customer partnership. Each business unit, within Henkel, has access to the

comprehensive range of adhesive technologies to offer customer solutions to their various bonding process requirements. Our business unit is focused on the development, production and sales of adhesives for the building and furniture industry.

Extended Product Portfolio

covering all important adhesive technologies, based on decades of experience within the involved companies.

Absolute Reliability

means for us not only a punctual delivery of high-quality products, products, manufactured to our continuous quality control standards, but also mindful of our economic and environmental responsibilities.

Adhesive Innovations

developed in close collaboration with our customers and supported through a large, worldwide operating network of experienced adhesive specialists.

Strong local Presence

means to you access to our experience of process optimization through well-trained adhesive specialists.

The Henkel Value Package

is a comprehensive and optimally-coordinated system of products and services for our customers.

LOCTITE®

TECHNOMELT®

TEROSON®

AQUENCE®

Typical Applications of Henkel Adhesives

1 Residential and Office Furniture



- > Living Room/Bedroom Furniture
- > Office Furniture

5 Flooring

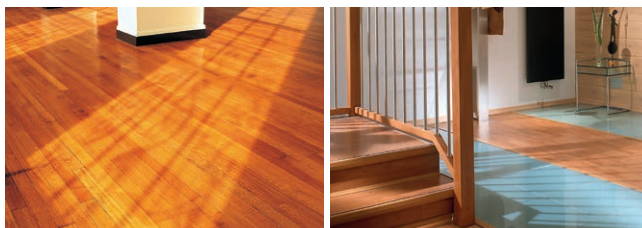

- > Parquet Flooring
- > Laminate Flooring

2 Kitchen and Bathroom Furniture

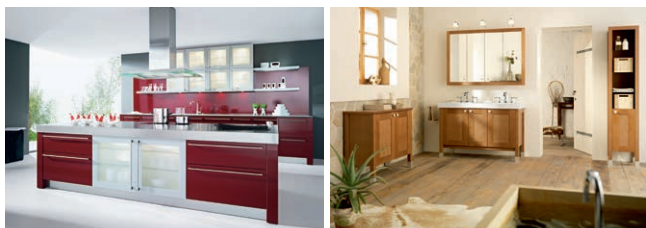

- > Kitchen Furniture
- > Bathroom Furniture

6 Windows and Window Parts

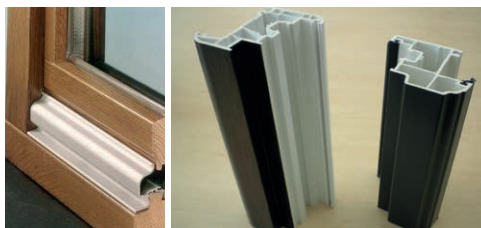

- > Wooden Windows
- > Window Profile Wrapping

3 Furniture Parts

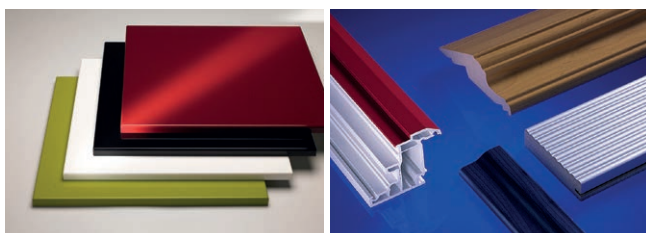

- > Furniture Fronts
- > Profiles

7 Doors



- > Interior and Exterior Doors
- > Garage Doors

4 Mattresses and Foam Bonding

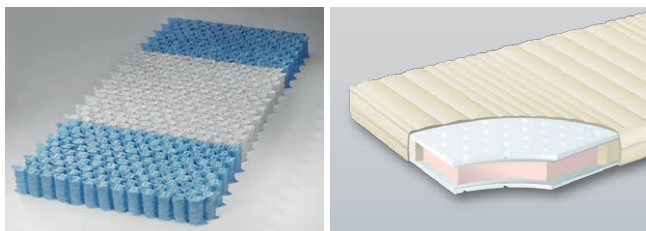

- > Mattresses
- > Upholstery

8 Wood Assembly/Millwork



- > Wood based Panels
- > Assembling

Henkel – Your Partner for

9 Panels

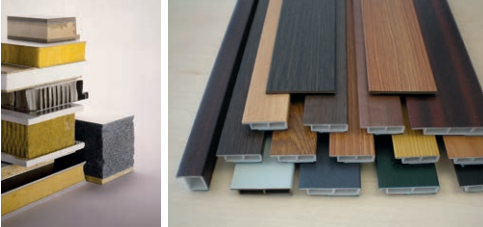

- > Sandwich Panels
- > Decorative Panels

10 Engineered Wood



- > Glulam, BSP/CLT, Finger Jointed Studs, I-Beams, I-Joists

11 Insulation

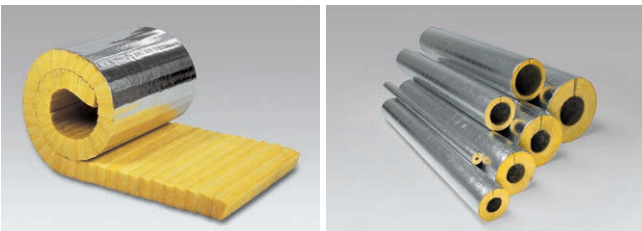

- > Mineral Wool Lamination
- > Pipe Wrapping

12 Roofing



- > Roofing Panels
- > Sealing

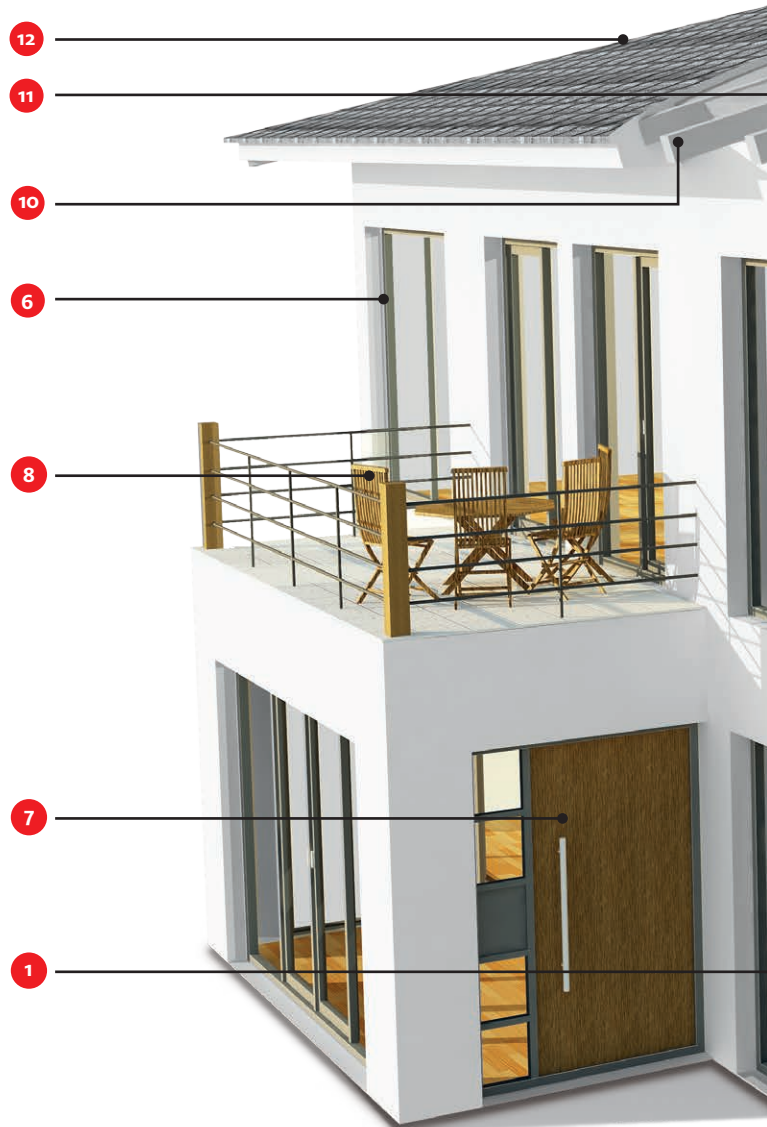

Building Components and Furniture Adhesives

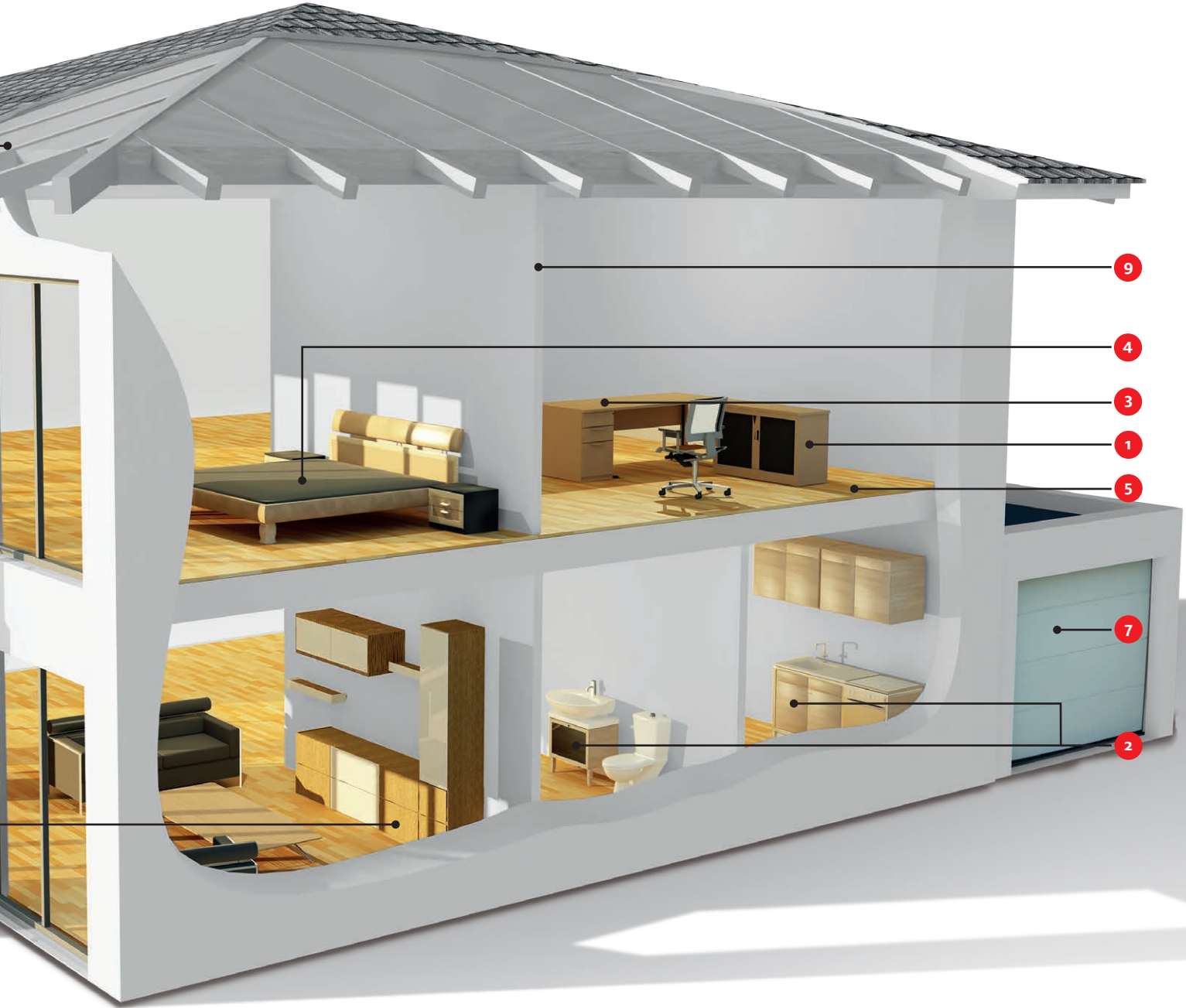

The Right Adhesive for all Applications

Reactive Hotmelt Adhesives – Polyurethane

PUR Hotmelt

2 3 6 7 9

- > For flat lamination, profile wrapping, edge banding and much more
- > Highest and durable moisture, heat and chemical resistance
- > Suitable for internal and external applications
- > Also available in granular form (ideal for starters and carpenters)

PUR Hotmelt MicroEmission®

2 3 6 7 9

- > Nonhazardous: Meets already today, the occupational safety standards of tomorrow

Reactive Hotmelt Adhesives – Acrylates

UV Curing Hotmelt

1 2 3 7 9

- > For the narrow surface sealing/edge improvement
- > For the sealing of working tops

UV Curing Hotmelt Coating

1 2 3 5 7 9

- > FUSION COATING for the high gloss upgrading of melamine faced panels
- > Highly wear resistant for floor and laminate applications

Thermoplastic Hotmelt Adhesives

Polypropylene (PP)

1 2 3 5 7 8 9

- > For edge banding, profile wrapping
- > High heat resistance
- > Very low application weights
- > Very clean machineability

EVA (Ethyl Vinyl Acetate)

1 2 3 4 5 7 9 11

- > For edge banding, profile wrapping and assembly
- > Clean processing by roller and nozzle
- > Considerably reduced cleaning effort

Polyolefins (APAO)

1 2 3 4 7 9 11

- > For profile wrapping and edge banding
- > High bond strength also at difficult to bond edge belts and wrapping foils
- > High heat resistance

Polyamide (PA)

2 3 9

- > Assembly bonding with very short setting time
- > Specialty products for postforming

Pressure Sensitive Adhesives (PSA)

4 5 11

- > Permanent sticky pressure-sensitive adhesives for versatile applications e.g. assembly adhesion
- > Coating of laminate flooring with impact noise (low applied quantities of 10g/m² possible)

Reactive 1C and 2C Polyurethane Adhesives

LOCTITE PURBOND

10

- > For load-bearing timber constructions
- > Certified according to international standards

PU-liquid Adhesives (1C and 2C)

3 7 8 9 10

- > For panel and sandwich elements
- > Solvent-free
- > Humidity and/or self crosslinking through adding of hardener
- > Consolidated and foamed gaps possible
- > For highest requirements (interior and exterior)

Dispersions

Polyurethane (1C and 2C)

2 3

- > 3D dispersions for the thermoforming process
- > Excellent spreading behavior
- > Extremely low reactivation temperature
- > Highest heat and moisture resistance

VAE (1C and 2C)

1 2 3 7 9

- > For flat lamination (PVC, paper)
- > High initial tack, even surface

PVAc (1C and 2C)

1 2 3 5 6 7 8 9 11

- > For assembly and surface bonding
- > Available in the water resistance groups D2, D3 and D4 (EN 204)
- > Very wide application window
- > Extremely high gap strength

EPI (2C)

5 6 8 10

- > Especially for difficult to bond wood species
- > Very high D4 (EN 204) and WATT'91 (EN 14257) values

Specialty Adhesives

MS-Polymer (1C and 2C)

2 3 6 7

- > Permanently elastic adhesions and sealants for the building industry
- > Isocyanate and silicone-free
- > Very good UV-resistance

Butyl Rubber

7 12

- > Versatile use for sealing of assembly parts
- > Available as butyl belt, barrel and cartridge packed

Your Individual Henkel Value Package

Our On-site Service for You

Start-up Support

- » Technical support during production start-up process through assistance of our Henkel specialists
- » A detailed start-up protocol is part of our Henkel service

Training

- » On your production line through our Henkel specialists
- » Optimization of process parameters for adhesive application

Quality Control

- » Support through our Henkel specialists for optimal adhesive usage
- » Checking of the current processing parameters
- » Quality check of produced parts
- » Detailed test report including proposals for establishing your quality assurance system

Consulting

- » Analysis of current production process with focus on the adhesive application
- » Definition of suitable improvements and performance measures

Our Service at Our Technology Center

Quality Control

- » Quality check in accordance to official standards and tailor-made tests

Training

- » Training on production lines for optimal adhesive usage
- » Individual designed programs
- » A detailed training manual is part of our Henkel service

LOCTITE®

TECHNOMELT®

TEROSON®

AQUENCE®

Regional Expertise

Our regional teams of well-trained and experienced adhesive technicians take care of your special requirements – in close collaboration with you and on site.

**We are just a few steps from you.
Nearly all over the world.**

Henkel Technology Center

Here we develop innovative adhesives and concepts for the improvement of production processes for our customers. Original production machines are used for the most important applications of the building and furniture industry such as edge banding, profile wrapping, flat lamination and 3D Thermoforming.

Our Services

- > Customer trials, training courses, product and machine demonstrations
- > Production of components for numerous applications
- > Examination of bonding and adhesive analyses

Henkel AG & Co. KGaA | Location Bopfingen

Kirchheimer Strasse 9

73441 Bopfingen | Germany

Phone: +49 7362 81-0

Fax: +49 7362 81-118

E-mail: wood@henkel.com | www.furniture-building-components.com